

Install Sheet

ZPC-2X // Wireless Pulse Counter

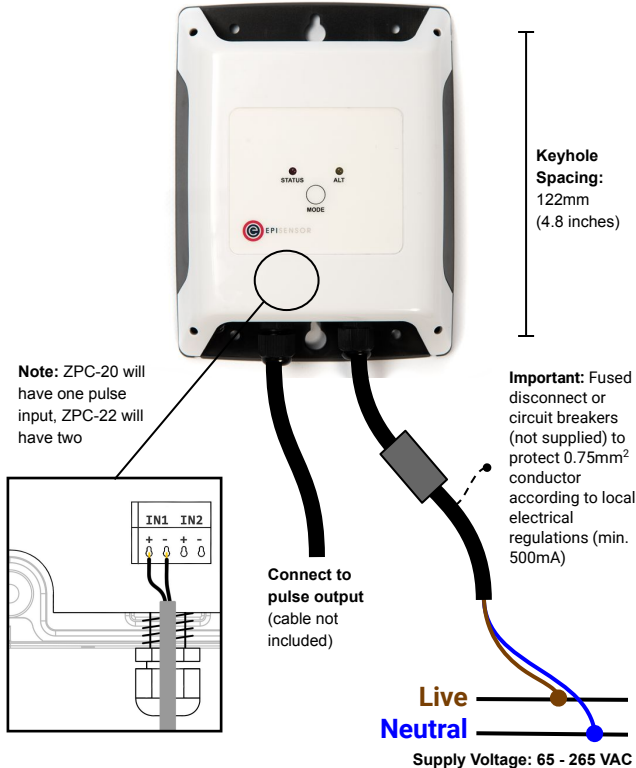

Wiring Diagram



Installation & Safety Notes



HAZARD OF ELECTRIC SHOCK, EXPLOSION, OR ARC FLASH



- EpiSensor equipment should be installed, operated, serviced and maintained only by qualified personnel. EpiSensor does not assume any responsibility for any consequences arising out of the use of this equipment.
- NEVER work alone.
- Use appropriate personal protective equipment (PPE) and follow safe electrical work practices.
- Turn off all power supplying the area in which the device is being installed before working on it.
- Always use a properly rated voltage sensing device to confirm that all power is off.
- The mains power supply is rated for up to 264 V AC. Consult the product datasheet for more information on safe operating conditions.
- Clearly label the device's disconnect circuit mechanism and install it within easy reach of the operator.
- The fuses / circuit breakers must be rated for the installation voltage and sized for the available fault current.